

1. About PRICOM H-260/H-260U

This chapter explains PRICOM operating environment, outline and how to connect PRICOM to the network.

Features

- Supports 10BASE-T and 100BASE-TX (Auto-detection).
- “Quick Setup” is included in the bundled CD-ROM for easy configuration.
- Management utility “AdminManager” is included in the bundled CD-ROM.
- Printing software “JC-Print2002” is included in the bundled CD-ROM.
- Embedded HTTP enables you to configure PRICOM via Web browser.
- Supports multi-protocol .
- Equipped with two printer interfaces.
 - Supports 2 multiple printer interfaces, a USB interface as well as a Hewlett Packard’s Enhanced Input/Output (EIO) interface, which enables purposed oriented printer choice, also sharing printing workloads between the connected printers and meantime saving the printers operational costs.
- Enhanced Windows XP compatibility
 - NetBIOS over TCP/IP is embedded. This allows NetBIOS printing environment to be configured on the PC running on Windows XP installed as the standard OS, without additional protocol installation.
- Additional security options
 - IP filter function is embedded to meet the advanced security needs.
 - This function limits the access to PRICOM by defining specific accessible IP addresses scopes. By disabling any access from IP addresses outside the defined specific range, the printer is securely protected from unauthorized accesses.
- Supports WINS (Windows Internet Name Service) environment
 - The NetBIOS name resolution with an associated IP address can be registered in WINS server.

-Embedded Pop-up Printer Status Monitoring

The embedded solution can monitor and alert in your PC screen for typical printer status such as paper out or error conditions.

HP-compatibility

PRICOM supports the compatible function of Hewlett-Packard's jetdirect print server series. This enables you to administrate via Web JetAdmin and also support jetdirect Printing Functions (Direct IPX Printing)

-Web JetAdmin-compatibility

PRICOM is compatible with Web JetAdmin and can be used for configuration and administration.

Web JetAdmin is a sophisticated network printer administration utility for use in large-scale intranet.



-PRICOM does not support all the features of Web JetAdmin.

-Refer to Web JetAdmin help option for the usage of Web JetAdmin.

-jetdirect port-compatibility

PRICOM is compatible with a HP jetdirect Port capability for peer-to-peer printing over IPX/SPX printing protocol.

Operating Environment

[Required devices to connect to network]

- Network Cable (category 5 or above in 100BASE-TX environment)
- Printer
- HUB

[Supported protocol/operating system]

<PRICOM H-260/H-260U>

- Supported protocol: TCP/IP, NetBEUI, IPX/SPX, AppleTalk
- Supported OS: Windows 95/98/Me, Windows NT 4.0, Windows 2000, Windows XP
UNIX, Linux
NetWare
Macintosh



NOTE

-When you use PRICOM in Macintosh environment, you need the printer driver for AppleTalk which is supplied with the printer.

Parts on PRICOM H-260/H-260U

Parts and Function



-The references to USB capability are applicable only for the H-260U product

TIP

Front panel

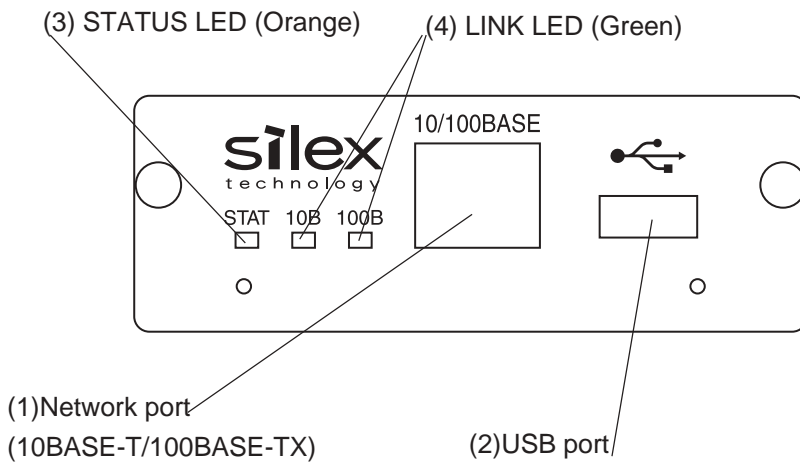

Dip Switch

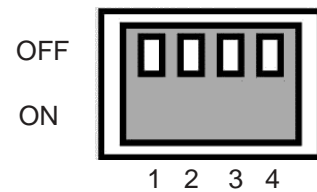

(5) Dip Switch (1-4)

(Front panel)

(1) Network Port (10BASE-100BASE-TX Auto-detection)

Connect to the network cable.

(2) USB port

Plug the USB cable.

(3)STATUS LED (Orange)

Flashes during data transfer

(4)10BASE LINK LED (Green)

Lights when a proper 10BASE network connection is established.

100BASE-TX LINK LED (Green)

Lights when a proper 100BASE-TX network connection is established.

(Dip Switch)

(5) Dip Switch

The following list describes the function of each switch.

1	OFF	Normal operating setting
2	OFF	Normal operating setting
	ON	Initialization/Reset to factory default upon power up
3	OFF	Normal operating setting
	ON	Prints Diagnostic/Configuration report upon power up
4	OFF	Normal operating setting

Dip Switch Operation



- Make sure to switch off printer when operating dip switches.
- If self-diagnostic shows you any NG, contact our customer support center.
- Diagnostic/configuration report can-not be printed depending on your printer.

<Initialization/Reset to factory default>

1. Switch off printer.
2. Switch on the dip switch No. 2.
3. Switch on printer and wait until the printer is ready for printing.
4. Switch off printer.
5. Switch off the dip switch No. 2.

<Diagnostic/Configuration report>

1. Switch off printer.
2. Switch on the dip switch No. 3.
3. Switch on printer and wait until configuration report is printed.
4. Switch off printer.
5. Switch off the dip switch No. 3.

Hardware installation

Connect PRICOM to the Printer



TIP

- Make sure to read the operating instructions of your printer before connecting PRICOM to the printer for proper use.
- Make sure the power cord of the printer is unplugged before attaching PRICOM to the printer.
- Prior to your installation, make sure to initialize PRICOM to factory default in case the PRICOM has been assigned with any IP address already in another network.

- 1.** Turn off the printer power supply, unplug the power cord, and then remove the EIO interface cover in the back of the printer.

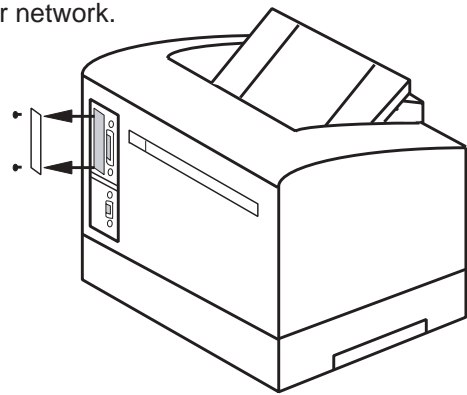

- 2.** Insert this product along the guide into the I/O slot .

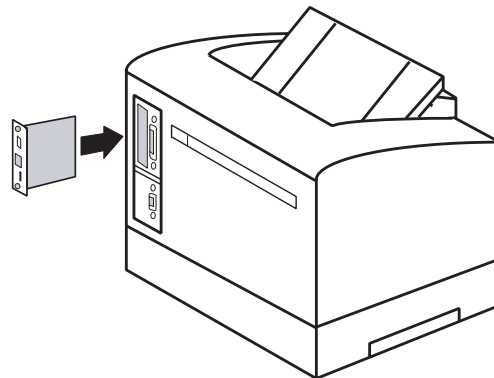

- 3.** Make sure that the printer power supply is switched off, and plug the power cord.

- 4.** Turn on the printer power, and make sure that the printer starts up normally.

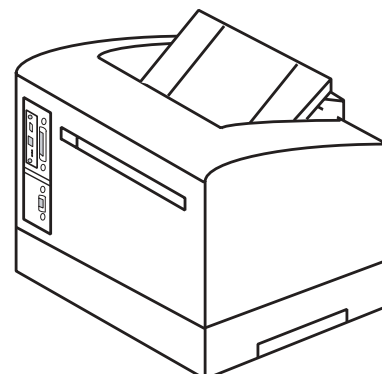

How to connect PRICOM to the network and the USB printer

The following items are required to connect PRICOM to the network.



- Prepare 100BASE supported Ethernet HUB and network cable (category 5 or above).
- You can not use PRICOM H-260/H-260U with a USB hub.

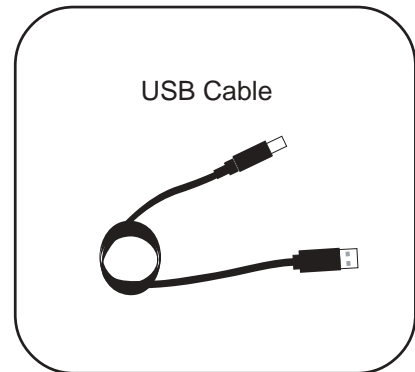
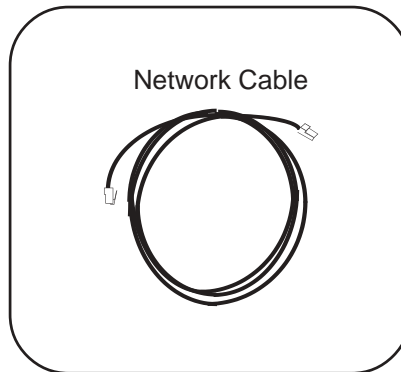
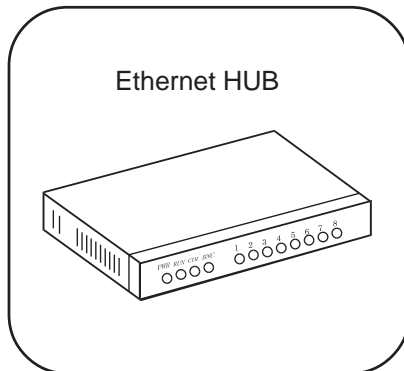

<How to connect this product to the network and the USB printer>

1. Switch off the printer power.
2. Connect the network cable to the network port of PRICOM.
3. Connect the other end of the network cable to the Ethernet HUB.
4. Plug the USB cable A-type into this product and plug the USB cable B-type into the printer.
5. Switch on the printer. Check the printer proper function.

